

STATE OF NORTH CAROLINA
DEPARTMENT OF TRANSPORTATION

PROJECT REFERENCE NO. 17BP.13.R.24 SHEET NO. SGN-1

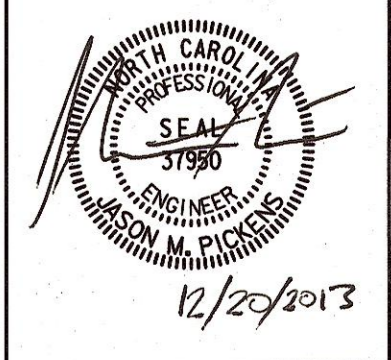

SIGNING PLAN
BUNCOMBE COUNTY

ROADWAY STANDARD DRAWING

THE FOLLOWING ROADWAY STANDARDS AS APPEAR IN "ROADWAY STANDARD DRAWINGS" - PROJECT SERVICES UNIT - N.C. DEPARTMENT OF TRANSPORTATION - RALEIGH, N.C., DATED JANUARY 2012 ARE APPLICABLE TO THIS PROJECT AND BY REFERENCE HEREBY ARE CONSIDERED A PART OF THESE PLANS:

STD. NO.	TITLE
904.10	ORIENTATION OF GROUND MOUNTED SIGNS
904.50	MOUNTING OF TYPE 'D', 'E' AND 'F' SIGNS ON 'U' CHANNEL POSTS

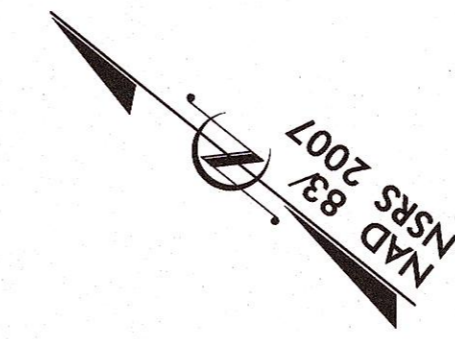

GENERAL NOTES

- SIGNS FURNISHED BY THE CONTRACTOR.
- IF REMOVAL OR RELOCATION OF SIGNS ON PRIVATE STREET (NON-STATE MAINTAINED) IS REQUIRED DUE TO CONSTRUCTION, THE CONTRACTOR SHALL INFORM THE ENGINEER. THE WORK WILL BE COMPLETED BY CONTRACTOR.
- WHEN NOT STATIONED OR DIMENSIONED ON PLANS, ALL 'E' AND 'F' SIGNS SHALL BE FIELD LOCATED BY THE ENGINEER
- ALL EXISTING SIGNS ON "U" CHANNEL POST WITHIN THE PROJECT LIMITS SHALL BE REMOVED AND DISPOSED OF UNLESS OTHERWISE NOTED ON PLANS.
- WHEN EXISTING SIGNS ARE REMOVED AND INSTALLED ON NEW SUPPORTS, THE RE-ERECTION SHALL IMMEDIATELY FOLLOW THE REMOVAL.
- THE BACKGROUND FOR TYPE E & F SIGNS SHALL BE TYPE C REFLECTIVE SHEETING.
- SEE ROADWAY PLANS FOR GUARD/GUIDE RAIL DETAILS.
- CAPACITIES FOR WEIGHT LIMIT SIGNS SHALL BE DETERMINED BY THE DEPARTMENT.

SUMMARY OF QUANTITIES

ITEM NO.		ITEM DESCRIPTION	QUANTITY	UNIT
DESC. NO.	SECT. NO.			
4025000000	901	CONTRACTOR FURNISHED TYPE E SIGN	29	S.F.
4072000000	903	SUPPORTS, 3 LB STEEL U-CHANNEL	60	L.F.
4102000000	904	SIGN ERECTION, TYPE E	4	EA.
4155000000	907	DISPOSAL OF SIGN SYSTEM, U-CHANNEL	4	EA.

PAY ITEM NOTES

1	DISPOSAL OF SIGN SYSTEM, U-CHANNEL
---	------------------------------------

"E" SIGNS

401 QUANTITY REQ'D _1_ 404 QUANTITY REQ'D _2_

30" X 30"
W1-2L

ONE "U" POST PER SIGN

402 QUANTITY REQ'D _1_

30" X 30"
W1-2R

ONE "U" POST PER SIGN

403 QUANTITY REQ'D _2_

18" X 18"
W13-1P

MOUNTED BELOW 401 & 402

WEIGHT LIMIT		24" X 36"
SINGLE VEHICLE	XX TONS	R12-3
TRUCK TRACTOR SEMITRAILER	XX TONS	

ONE "U" POST PER SIGN

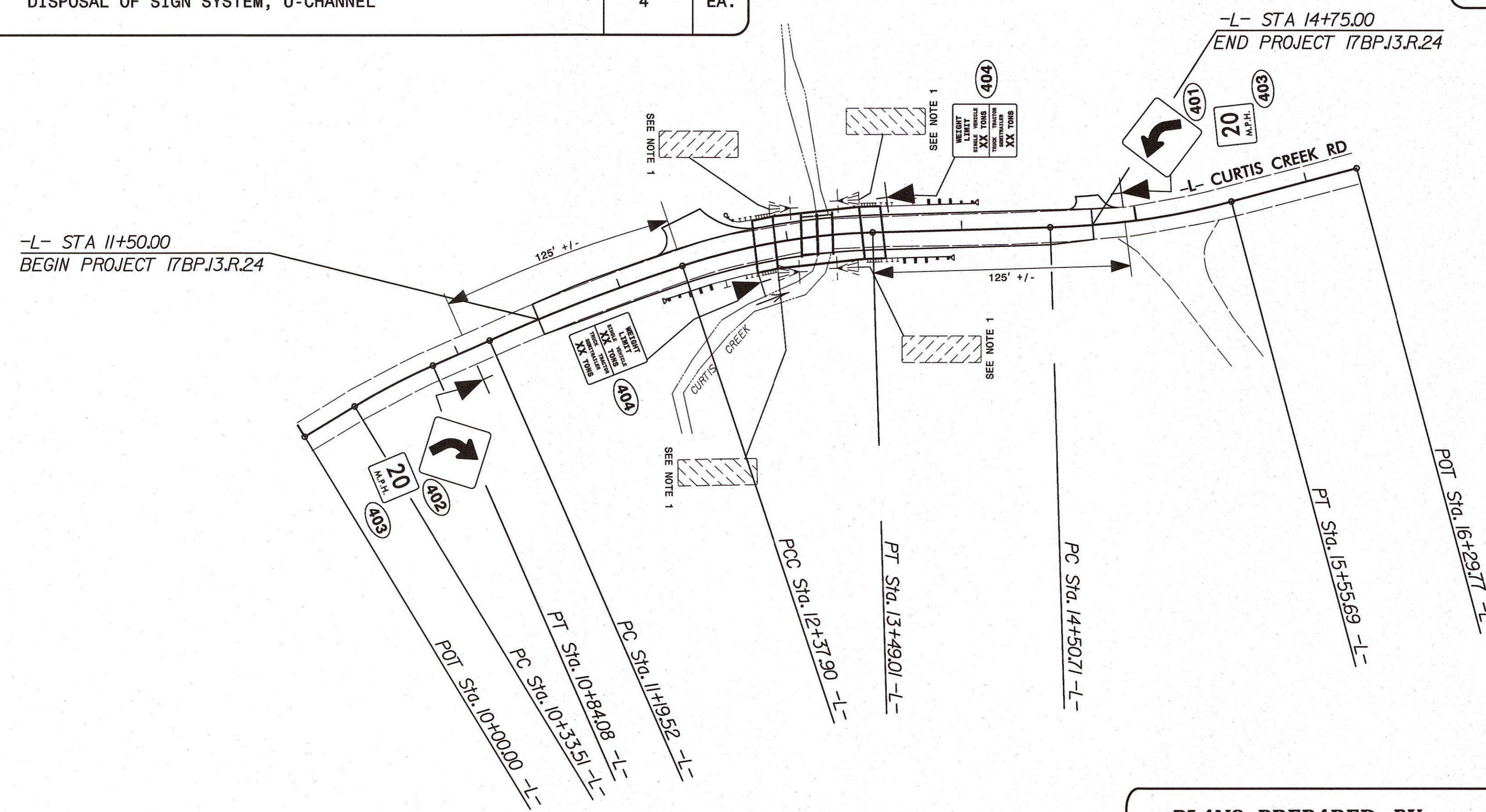

PLAN REVIEWED BY: N.C.D.O.T. SIGNING AND DELINEATION UNIT

SIGNING & DELINEATION REGIONAL ENGINEER

SIGNING & DELINEATION PROJECT DESIGN ENGINEER

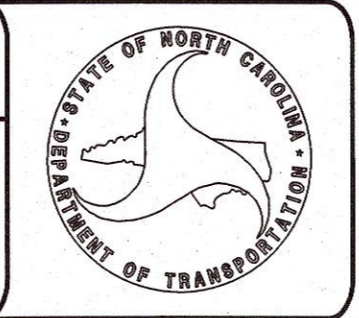

PLANS PREPARED BY:

ED ROBBINS, P.E. PROJECT MANAGER

J. MATTHEW PICKENS, P.E. PROJECT ENGINEER

PLANS PREPARED BY:

PARSONS

FOR
DIVISION OF HIGHWAYS

11-NOV-2013 13:08
 J:\Buncom\271\Roadway\Proj\BUNCOM_271_SGN_SGN-1.dgn
 \$\$\$USERNAME\$\$\$

CROSS-SECTION SUMMARY

Station	Uncl. Exc.	Embt	Station	Uncl. Exc.	Embt	Station	Uncl. Exc.	Embt	Station	Uncl. Exc.	Embt	Station	Uncl. Exc.	Embt	Station	Uncl. Exc.	Embt
L DET	(cu. yd.)	(cu. yd.)		(cu. yd.)	(cu. yd.)		(cu. yd.)	(cu. yd.)		(cu. yd.)	(cu. yd.)		(cu. yd.)	(cu. yd.)		(cu. yd.)	(cu. yd.)
12+00.00	0	0															
12+25.00	6	0															
12+50.00	13	0															
12+75.00	21	0															
12+92.00	12	2															
13+00.00	3	2															
13+25.00	16	16															
13+42.00	9	12															
13+50.00	2	3															
13+75.00	7	8															
14+00.00	8	3															
14+25.00	12	0															
Station	Uncl. Exc.	Embt															
L RT	(cu. yd.)	(cu. yd.)															
11+50.00	0	0															
11+75.00	0	1															
12+00.00	0	2															
12+25.00	0	3															
12+50.00	0	5															
12+75.00	0	11															
Skip Station Range 12+91.85 to 13+44.15																	
13+42.00	5	10															
13+50.00	4	3															
13+75.00	18	4															
14+00.00	17	0															
14+25.00	19	1															
14+50.00	22	1															
Station	Uncl. Exc.	Embt															
L LT	(cu. yd.)	(cu. yd.)															
11+50.00	0	0															
11+75.00	2	1															
12+00.00	3	1															
12+25.00	2	3															
12+50.00	0	6															
12+75.00	1	11															
12+92.00	1	11															
Skip Station Range 12+91.85 to 13+44.15																	
13+25.00	0	1															
13+42.00	0	0															
13+50.00	2	2															
13+75.00	0	11															
14+00.00	0	10															
14+25.00	0	14															
14+50.00	0	8															
14+75.00	0	0															

Approximate quantities only. Unclassified excavation, borrow excavation, shoulder borrow, fine grading, clearing and grubbing, and removal of existing pavement will be paid for at the lump sum price for "Grading".

5/14/99
 J:\Bunc 271\Roadway\XSC\BUNC-271-L-Redy-xpl-x0.dgn
 2025/05/14 09:42:00

8/23/99



PROJ. REFERENCE NO.
17BP.13.R.24

SHEET NO.
X-1

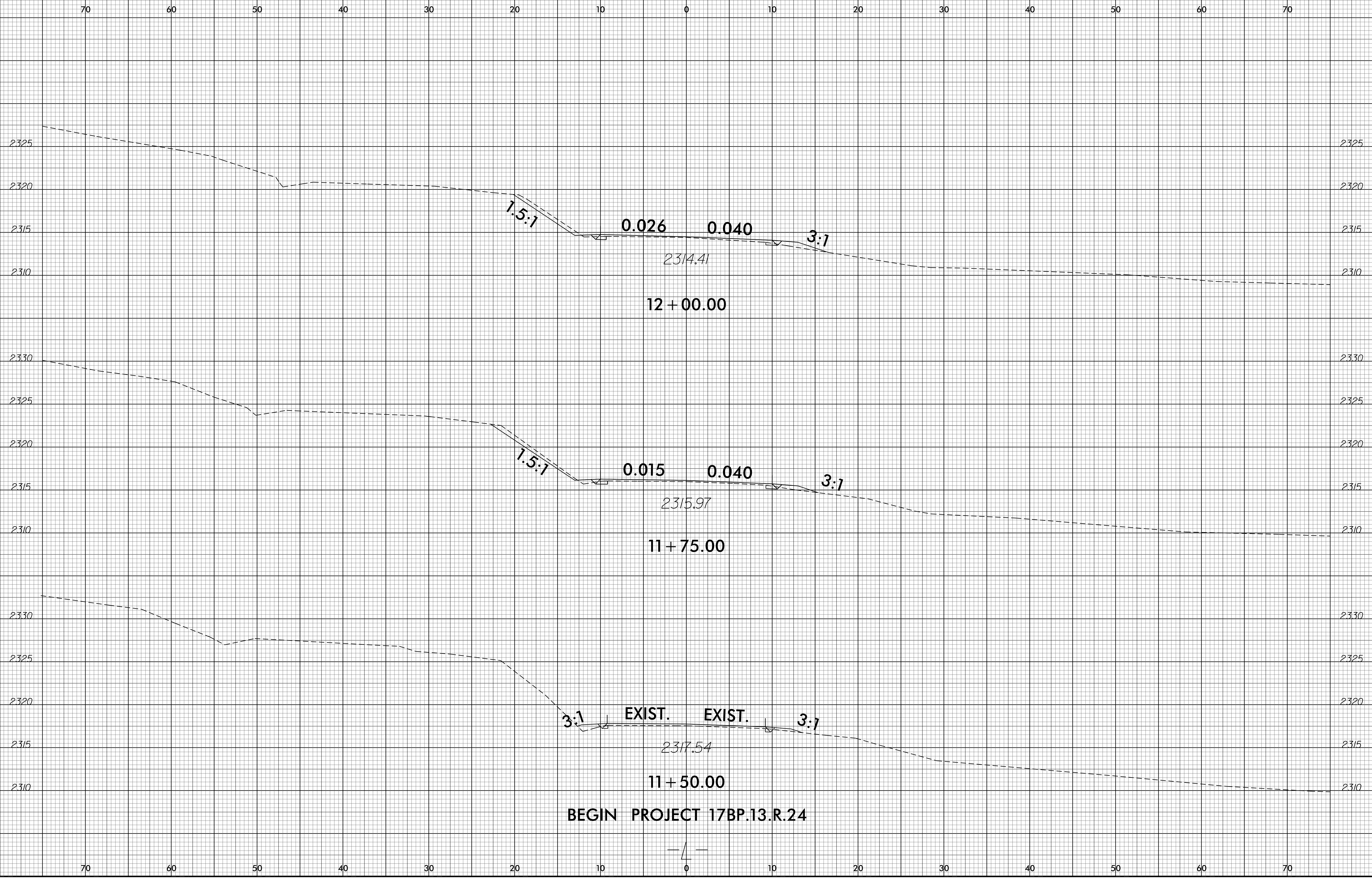

I:\DEC-2013\1546
17BP.13.R.24\17BP.13.R.24.X-1.dwg
12/15/13 10:46 AM
SUB: 17BP.13.R.24

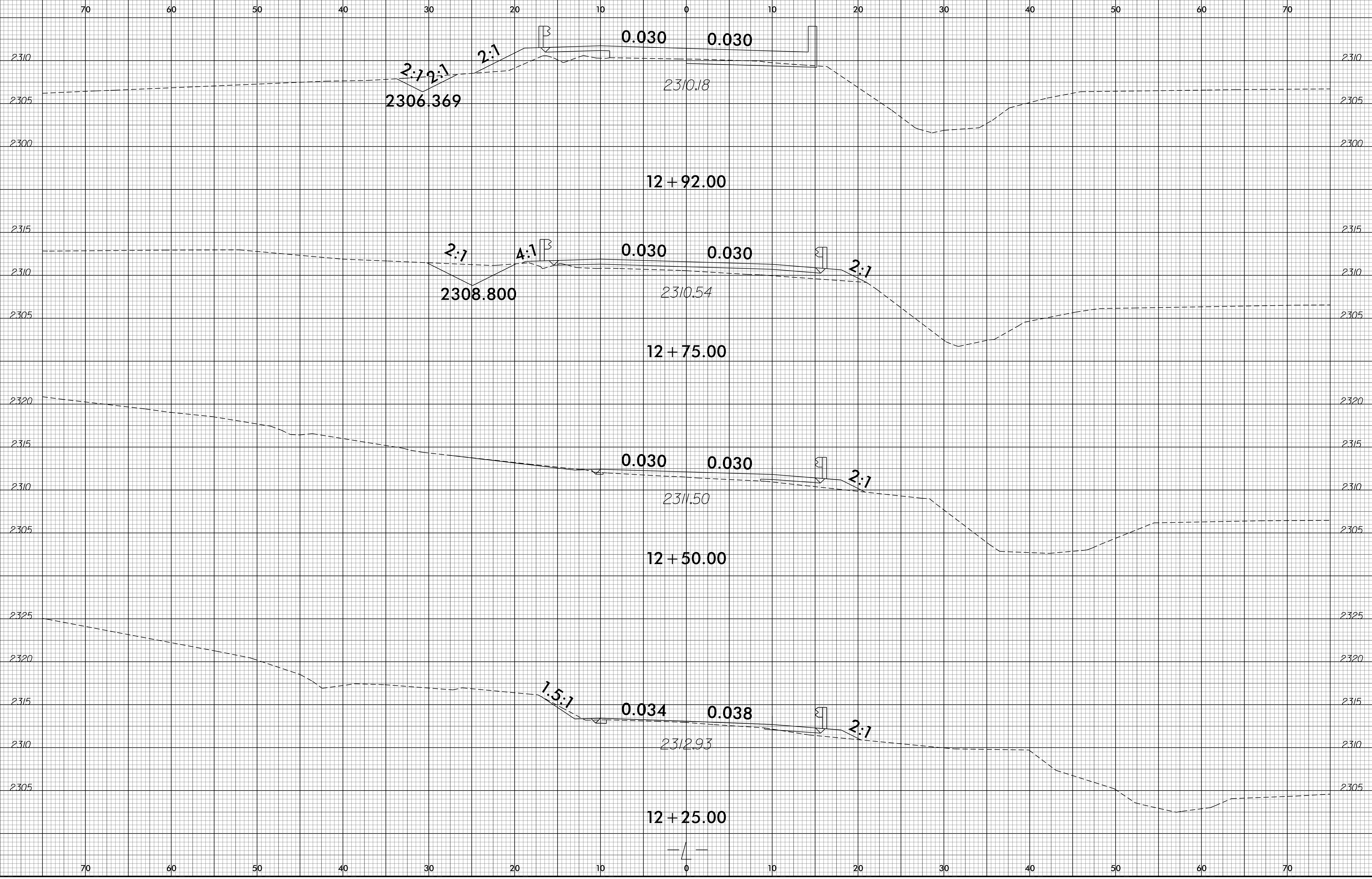

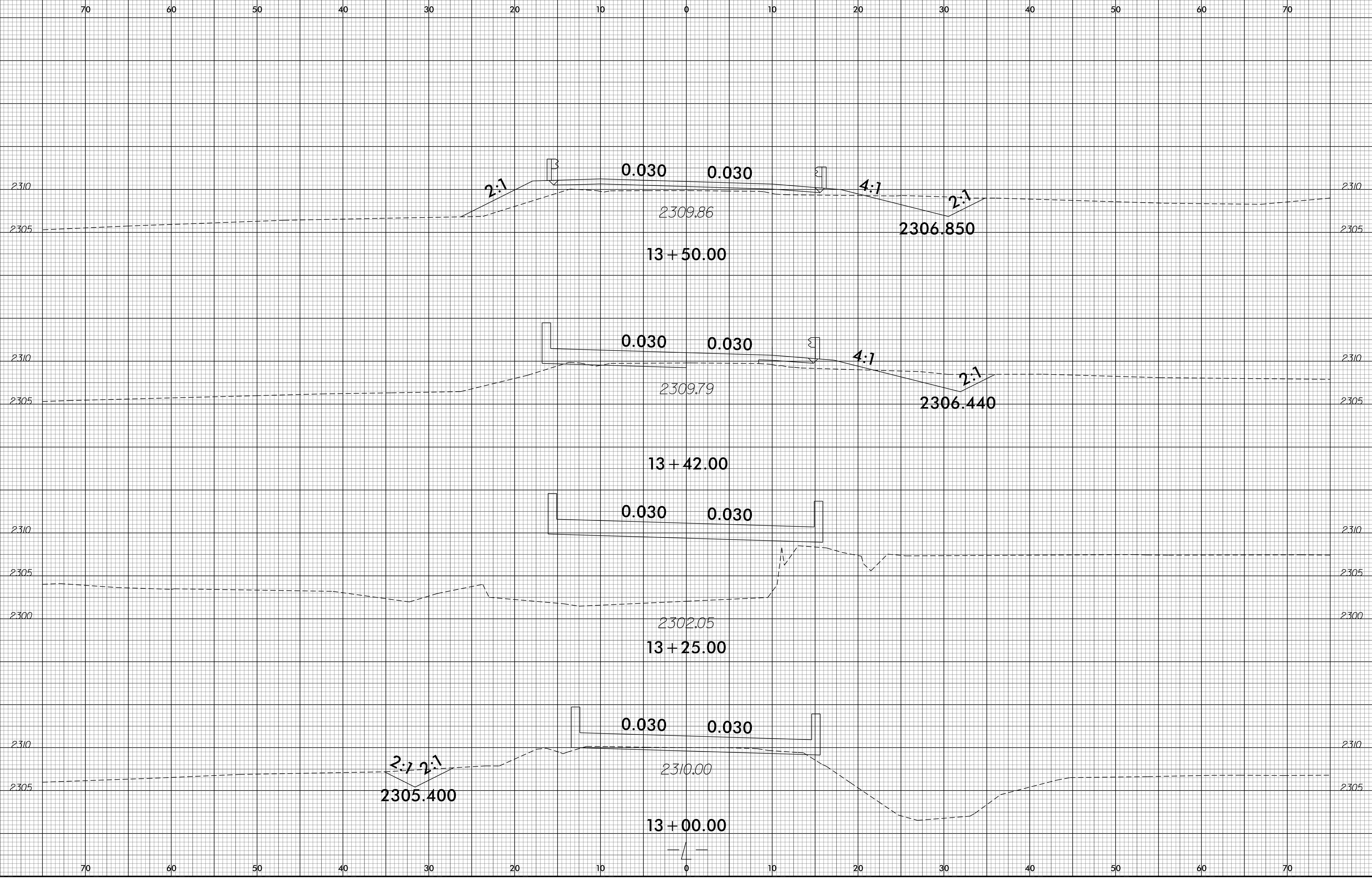
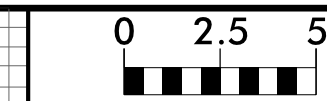

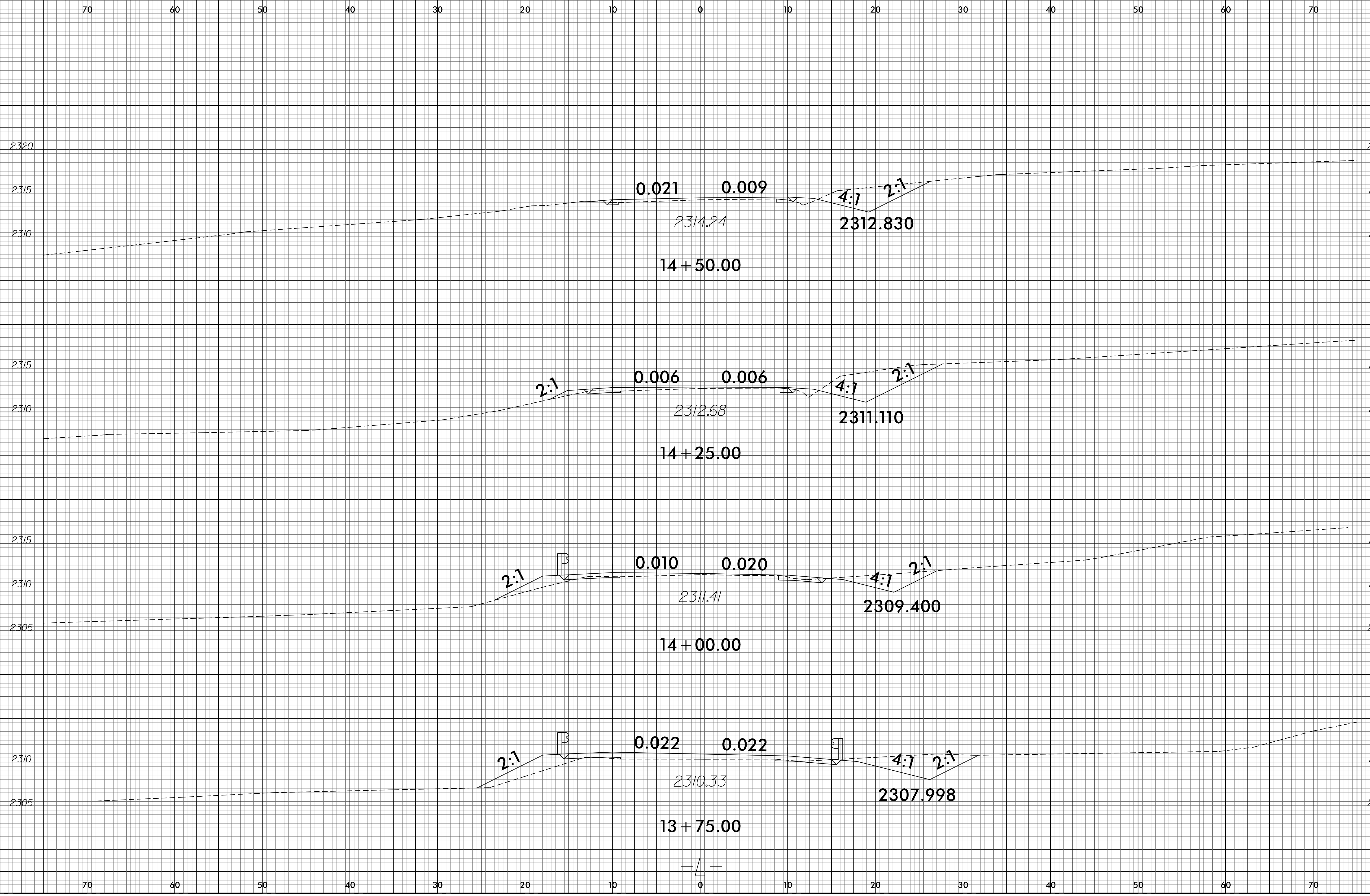

8/23/99



PROJ. REFERENCE NO.
17BP.13.R.24

SHEET NO.
X-5

70 60 50 40 30 20 10 0 10 20 30 40 50 60 70

END PROJECT 17BP.13.R.24

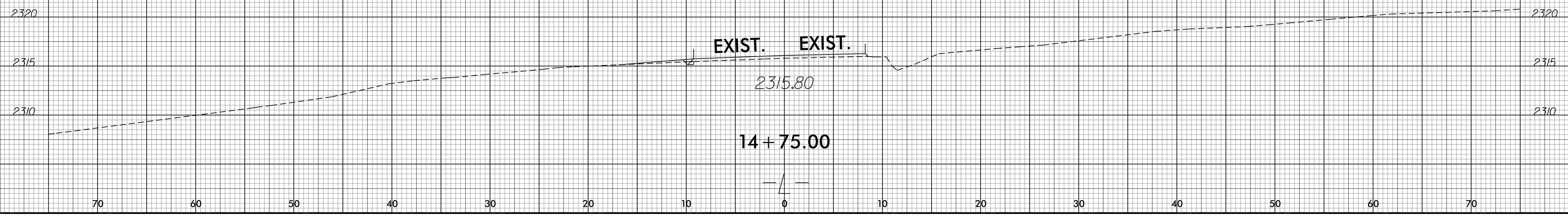

20-NOV-2013 09:35
I:\BUNG\A\Feeds\XSC\BUNC_271_Rdy_xpl_No2_120525.dgn
SUBER

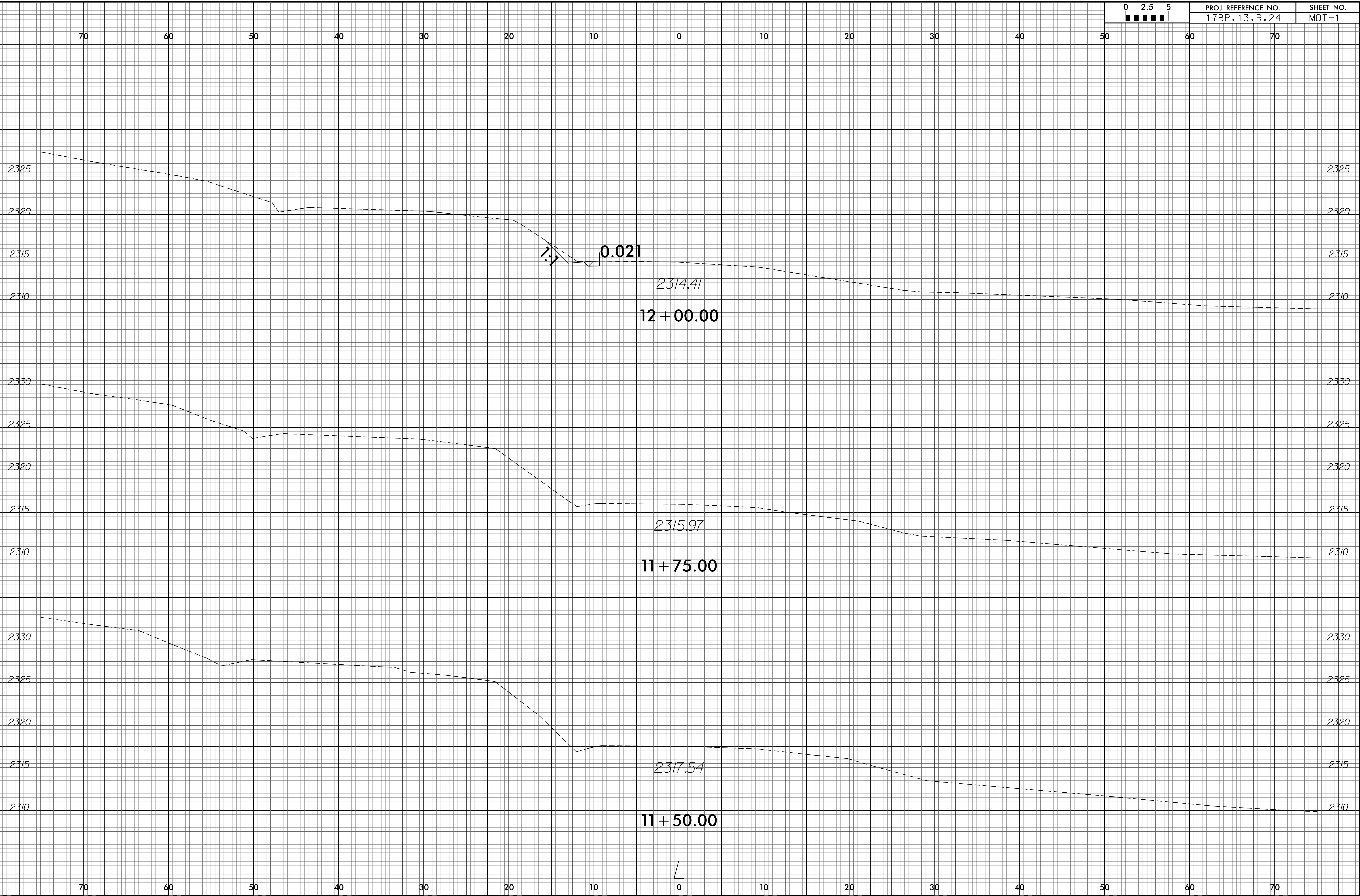

8/23/99



PROJ. REFERENCE NO.
17BP.13.R.24

SHEET NO.
MOT-2

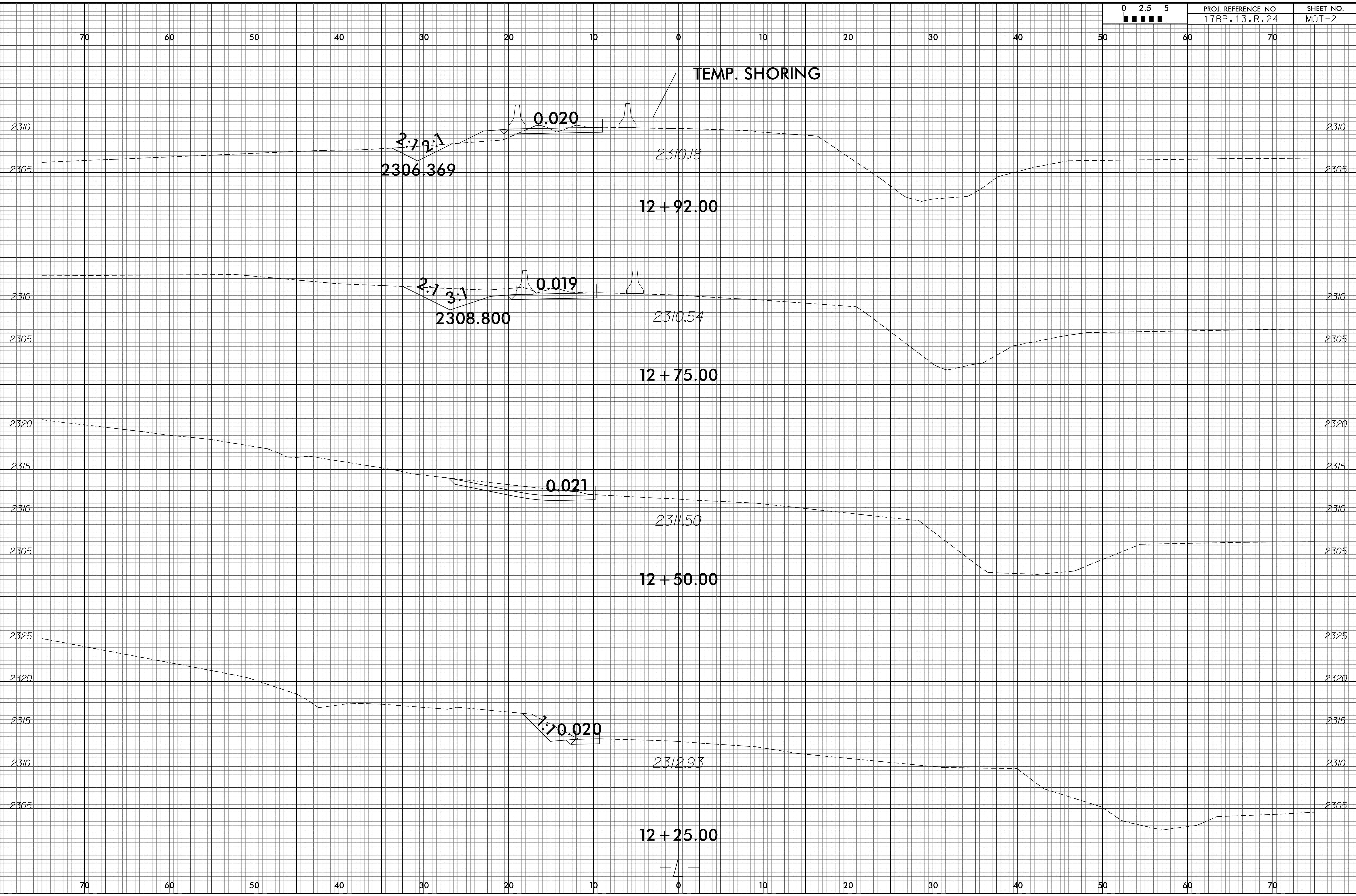

30-DEC-2013 14:30
J:\BUN\271\120523.dgn
SUBPROJECT

